



Vetus

SPARE PARTS

2014-2015

PARTS GUIDES

CREATORS OF

BOAT SYSTEMS

VETUS SPARE PARTS



Why Vetus Parts?

You can always trust VETUS genuine spares when replacing parts on your boat. By using genuine spares you ensure that everything on your boat works as it did when new. Also, by using genuine spares, you maintain your warranty.

VETUS uses tight tolerances and strict quality control to give a longer service life and the best possible performance.

VETUS lubricants and coolants are carefully selected to prolong service life as well as offering the best performance.

For tips on installation or to find a dealer please visit www.vetus.com





ENGINE	SERVICE KIT	OILFILTER	FUELFILTER	IMPELLER	V-BELT	V-BELT RAWWATERPUMP
M2.02	STM9531	STM0051	STM3690	STM8076	STM7439	N/A
M2.04	STM9531	STM0051	STM3690	STM8076	STM7369	N/A
M2.05	STM9530	STM0051	STM3690	STM8076	STM3669	N/A
M2.C5	STM9531	STM0051	STM3690	STM8076	STM7439	N/A
M2.D5	STM9531	STM0051	STM3690	STM8076	STM7439	N/A
M2.06	STM9531	STM0051	STM3690	STM8076	STM7439	N/A
M3.09	STM9531	STM0051	STM3690	STM8076	STM7369	N/A
M3.10	STM9532	STM0051	STM3690	STM8076	STM1656	N/A
M3.28	STM9838	STM0051	STM3690	STM8076	STM7439	N/A
M4.14	STM9533	STM0051	STM3690	STM8076	STM1661	N/A
M4.15	STM9543	STM0051	STM3690	STM8076	STM7966	N/A
M4.17	STM9543	STM0051	STM3690	STM8076	STM7966	N/A
M4.55 (110A)	STM9471	STM0051	STM3690	STM8074	STM7643	N/A
M4.55 (110A+110A)	STM9472	STM0051	STM3690	STM8074	STM7643+STM9858	N/A
M4.55 (110A+75A)	STM9473	STM0051	STM3690	STM8074	STM7643+STM9857	N/A
P4.17	STM9534	STM9316	STM3690	STM8074	STM6528	N/A
P4.19	STM9534	STM9316	STM3690	STM8074	STM6528	N/A
P4.25	STM9535	STM9316	STM9028	STM8075	STM1607	N/A
VH4.65	STM9546	STM4910	STM3690	STM8074	STM4509	STM4523
VH4.80	STM9547	STM4910	STM3690	STM8074	STM4509	STM4523
VF4140	STM9548	STM9452	STM9451	STM9453	N/A	N/A
VF4170	STM9548	STM9452	STM9451	STM9453	N/A	N/A
VF4190	STM9548	STM9452	STM9451	STM9453	N/A	N/A
VF5220	STM9548	STM9452	STM9451	STM9453	N/A	N/A
VF5250	STM9548	STM9452	STM9451	STM9453	N/A	N/A
D4.29	STM9536	VD20290	VD60092	STM8811	STM6023	STM8533
DT4.29	STM9536	VD20290	VD60092	STM8811	STM6023	STM8533
DT4.70	STM9542	08-00085	STM3690	STM8074	08-00083	N/A
DT4.85	STM9542	08-00085	STM3690	STM8074	08-00083	N/A
DT43	STM9538	VD20262	VD60092	STM8250	STM8293	STM8778



ENGINE	SERVICE KIT	OILFILTER	FUELFILTER	IMPELLER	V-BELT	V-BELT RAWWATERPUMP
DTA43	STM9538	VD20262	VD60092	STM8250	STM8293	STM8778
DT44	STM9538	VD20262	VD60210	STM8250	STM9725	VD20723
DTA44	STM9538	VD20262	VD60210	STM8250	STM9725	VD20723
DT64	STM9539	VD20263	VD60092	STM8250	STM8293	STM8778
DTA64	STM9539	VD20263	VD60092	STM8250	STM8293	STM8778
DT66	STM9540	VD20263	VD60092	STM8250	STM9725	VD20723
DTA66	STM9540	VD20263	VD60092	STM8250	STM9725	VD20723
DT67	STM9541	VD20263	VD60210	STM8250	STM8533	STM8779
DTA67	STM9541	VD20263	VD60210	STM8250	STM8533	STM8779
F1.03	STM9549	VF20109	VF60058	STM7180	N/A	N/A

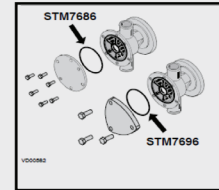
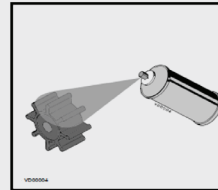
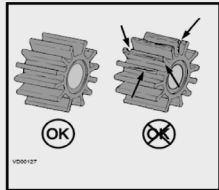
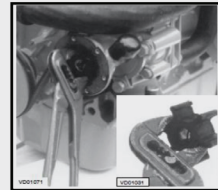
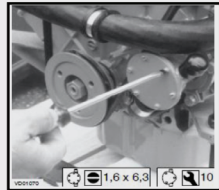
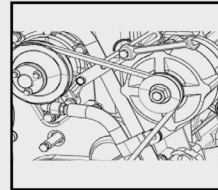
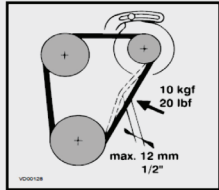
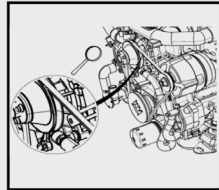
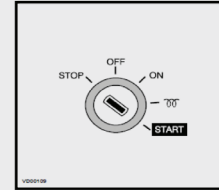
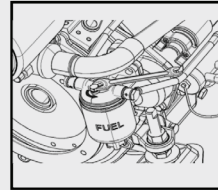
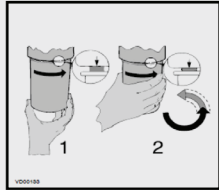
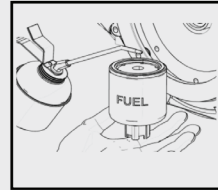
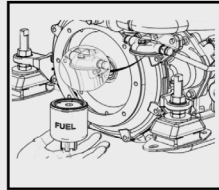
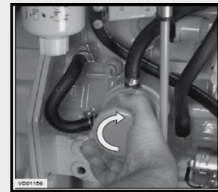
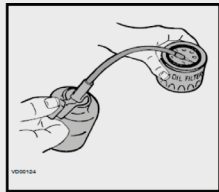
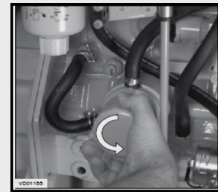
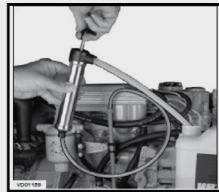



<i>FILTER TYPE</i>	<i>HOSE CONNECTION</i>	<i>O-RING</i>	<i>MOUNTING SET</i>	<i>CLAMP</i>	<i>DRAINPLUG / MIXER</i>
NLP40	US001	US004	SET0054	NLP1K	DRAIN
NLP45	US002	US004	SET0054	NLP1K	DRAIN
NLP50	US003	US004	SET0054	NLP1K	DRAIN
NLP50S	SET0001	N/A	SET0055	SET0053	DRAIN
NLP60	SET0002	N/A	SET0055	SET0053	DRAIN
NLP75	SET0003	N/A	SET0055	SET0053	DRAIN
NLP90	SET0004	N/A	SET0055	SET0053	DRAIN
NLPH40	US001	US004	N/A	NLPG03	DRAIN
NLPH45	US002	US004	N/A	NLPG03	DRAIN
NLPH50	US003	US004	N/A	NLPG03	DRAIN
NLPH60	SET0002	N/A	N/A	NLPH02	DRAIN
NLPH75	SET0003	N/A	N/A	NLPH02	DRAIN
NLPH90	SET0004	N/A	N/A	NLPH02	DRAIN
NLPG40	US001	US004	N/A	NLPG03	DRAIN
NLPG45	US002	US004	N/A	NLPG03	DRAIN
NLPG50	US003	US004	N/A	NLPG03	DRAIN
NLPG60	SET0002	N/A	N/A	NLPG02	DRAIN
NLPG75	SET0003	N/A	N/A	NLPG02	DRAIN
NLPG90	SET0004	N/A	N/A	NLPG02	DRAIN
NLP340	US001	US004	N/A	NLPG03	DRAIN
NLP345	US002	US004	N/A	NLPG03	DRAIN
NLP350	US003	US004	N/A	NLPG03	DRAIN
WLOCKL40R	US001	US004	N/A	N/A	DRAIN
WLOCKL45R	US002	US004	N/A	N/A	DRAIN
WLOCKL50R	US003	US004	N/A	N/A	DRAIN
WLOCKL50S	N/A	N/A	N/A	N/A	DRAIN
WLOCKL60S	N/A	N/A	N/A	N/A	DRAIN
WLOCKL75S	N/A	N/A	N/A	N/A	DRAIN
WLOCKL90S	N/A	N/A	N/A	N/A	DRAIN



<i>FILTER TYPE</i>	<i>HOSE CONNECTION</i>	<i>O-RING</i>	<i>MOUNTING SET</i>	<i>CLAMP</i>	<i>DRAINPLUG / MIXER</i>
LSS40A	US001	US004	N/A	N/A	DRAIN
LSS45A	US002	US004	N/A	N/A	DRAIN
LSS50A	US003	US004	N/A	N/A	DRAIN
LSL60	SET0002	N/A	N/A	N/A	DRAIN
LSL75	SET0003	N/A	N/A	N/A	DRAIN
LSL90	SET0004	N/A	N/A	N/A	DRAIN
LGS4038	US001	US004	N/A	N/A	DRAIN
LGS4538	US002	US004	N/A	N/A	DRAIN
LGS5038	US003	US004	N/A	N/A	DRAIN
LGS6050	SET0002	N/A	N/A	N/A	DRAIN
LGS7550	SET0003	N/A	N/A	N/A	DRAIN
MV090	N/A	N/A	SETBKB205	N/A	MIXER090
MV100	N/A	N/A	SETBKB205	N/A	MIXER100
MV125	N/A	N/A	SETBKB315	N/A	MIXER125
MV150	N/A	N/A	SETBKB315	N/A	MIXER150
MF090	N/A	N/A	SETBKB205	N/A	MIXER090
MF100	N/A	N/A	SETBKB205	N/A	MIXER100
MF125	N/A	N/A	SETBKB315	N/A	MIXER125
MF150	N/A	N/A	SETBKB315	N/A	MIXER150
MGP9090	N/A	N/A	MGVIB45	N/A	DRAIN
MGP5455	N/A	N/A	MGVIB45	N/A	DRAIN
MGP102102	N/A	N/A	MGVIB45	N/A	DRAIN
MGP102127	N/A	N/A	MGVIB45	N/A	DRAIN
MGS5455A	N/A	SETMGS	MGVIB55 + SET0050A	N/A	DRAIN
MGS5456A	N/A	SETMGS	MGVIB55 + SET0050A	N/A	DRAIN
MGS6456A	N/A	SETMGS	MGVIB55 + SET0050A	N/A	DRAIN
MGL6458A	N/A	MSETMGL	MGVIB55 + SET0051A	N/A	DRAIN
MGL8458A	N/A	MSETMGL	MGVIB55 + SET0051A	N/A	DRAIN
MGL84510A	N/A	MSETMGL	MGVIB55 + SET0051A	N/A	DRAIN



<i>FILTER TYPE</i>	<i>COVER + O-RING</i>	<i>O-RING / GASKET SETS</i>	<i>BASKET</i>	<i>MOUNTING SET</i>
FTR140/13	FTR14001	FTR14002	FTR41	MBSET03
FTR140/16	FTR14001	FTR14002	FTR41	MBSET03
FTR140/19	FTR14001	FTR14002	FTR41	MBSET03
FILTER150	WF09	WF10	WF12	MBSET05
FTR330/13	FTR3301	FTR3302	FTR05	MBSET05
FTR330/16	FTR3301	FTR3302	FTR05	MBSET05
FTR330/19	FTR3301	FTR3302	FTR05	MBSET05
FTR330/25	FTR3301	FTR3302	FTR05	MBSET05
FTR330/32	FTR3301	FTR3302	FTR05	MBSET05
FTR330/38	FTR3301	FTR3302	FTR05	MBSET05
FTR525	WF25+WF27	WF27	WF525	SETBKB170
FTR132038	FTR13201	FTR13202	SET0187	SETBKB140
FTR132050	FTR13201	FTR13202	SET0187	SETBKB140
FTR132063	FTR13201	FTR13202	SET0187	SETBKB140



VENT TYPE	DORADEBOX	RING	COVER PLATE / SCREEN	MOUNTING RING/SET	COUNTER FLANGE	KNOB	GASKET/SWITCH
DON316R	BOX75 / BOXS75 / DJBOX	RING75	SET75	VE87	N/A	N/A	N/A
DON316WR	BOX75 / BOXS75 / DJBOX	RING75	SET75	VE87	N/A	N/A	N/A
DONALD2	BOX75 / BOXS75 / DJBOX	RING75 / DJRING	SET75	VE75B / VE75S / VE75SET	N/A	N/A	N/A
DONALDS	BOX75 / BOXS75 / DJBOX	RING75 / DJRING / VE27	SET75	VE27	N/A	N/A	N/A
JER316R	BOX75 / BOXS75 / DJBOX	RING75	SET75	VE87	N/A	N/A	N/A
JER316WR	BOX75 / BOXS75 / DJBOX	RING75	SET75	VE87	N/A	N/A	N/A
JERRY2	BOX75 / BOXS75 / DJBOX	RING75 / DJRING	SET75	VE75B / VE75S / VE75SET	N/A	N/A	N/A
JERRYS	BOX75 / BOXS75 / DJBOX	RING75 / DJRING	SET75	VE27	N/A	N/A	N/A
TOM316R	BOX100 / BOXS100 / TBOX	RING100	SET100	VE87	N/A	N/A	N/A
TOM316WR	BOX100 / BOXS100 / TBOX	RING100	SET100	VE87	N/A	N/A	N/A
TOM2	BOX100 / BOXS100 / TBOX	RING100 / TRING	SET100	VE100B / VE100S / VE100SET	N/A	N/A	N/A
TOMS	BOX100 / BOXS100 / TBOX	RING100 / TRING	SET100	VE28	N/A	N/A	N/A
YOG316R	BOX125 / BOXS125 / YBOX	RING125	SET125	VE87	N/A	N/A	N/A
YOG316WR	BOX125 / BOXS125 / YBOX	RING125	SET125	VE87	N/A	N/A	N/A
YOGI2	BOX125 / BOXS125 / YBOX	RING125 / YRING	SET125	VE87 / VE125B / VE125S / VE125SET	N/A	N/A	N/A
YOGIS	BOX125 / BOXS125 / YBOX	RING125	SET125	VE87	N/A	N/A	N/A
UFOTR	N/A	VE47	N/A	VE48 (LENS)	N/A	N/A	N/A



VENT TYPE	DORADEBOX	RING	COVER PLATE / SCREEN	MOUNTING RING/SET	COUNTER FLANGE	KNOB	GASKET/SWITCH
PORTOS1	N/A	N/A	N/A	N/A	VE75	KNOP0840G	N/A
ATHOS1	N/A	N/A	N/A	N/A	VE10	KNOP1040G	N/A
DARTAGN1	N/A	N/A	N/A	N/A	VE105	KNOP1040G	N/A
UFO	N/A	N/A	N/A	N/A	VE40	N/A	VE39
UFO2	N/A	N/A	N/A	N/A	N/A	KNOP0840G	N/A
FAN12	N/A	N/A	N/A	N/A	N/A	N/A	FAN004
FAN24	N/A	N/A	N/A	N/A	N/A	N/A	FAN004

NEW PRODUCT

SILICONE COWL VENTILATORS

Code	SAMOEN(S)	CHINOOK(S)	LIBEC(S)	TRAMON(S)
Free air flow area	76 cm ²	45 cm ²	30 cm ²	30 cm ²
Colour	white/red	white/red	white/red	white/red
Ring type	Rotatable, plastic. (Hard plastic)	Rotatable, plastic. (Hard plastic)	Rotatable, plastic. (Hard plastic)	Rotatable, plastic. (Hard plastic)
Dimensions				





PRODUCT. NO	QUANTITY	DESCRIPTION
TMWB002	1	TMW bowl, glazed ceramics
TMWB001	1	Seatlid, synthetic, soft close, quick release
TMWB008	2	Mounting cap, screw cover white
TMWBP	1	Panel 12/24V Incl. frame+screw+gaskets
TMWBS	1	Rocker switch. Assembly white. Incl. Wire+plug
TMWB007	1	Water supply hose G3/4
TMWB019	1	Discharge 19mm. Needs hose clamp D20-32mm
TMWB025	1	Discharge 25mm. Needs hose clamp D32-50mm
TMWB038	1	Discharge 38mm. Needs hose clamp D32-50mm
TMWB006	1	Discharge tube
TMWB010	1	Duckbill
TMWB011	1	Inlet elbow
TMWB112	1	Macerator 12V assembly complete, incl. pump and motor
TMWB124	1	Macerator 24V assembly complete, incl. pump and motor
TMWB212	1	Control unit assembly 12V
TMWB224	1	Control unit assembly 24V
TMWB013	1	Water supply (elbow and gasket)

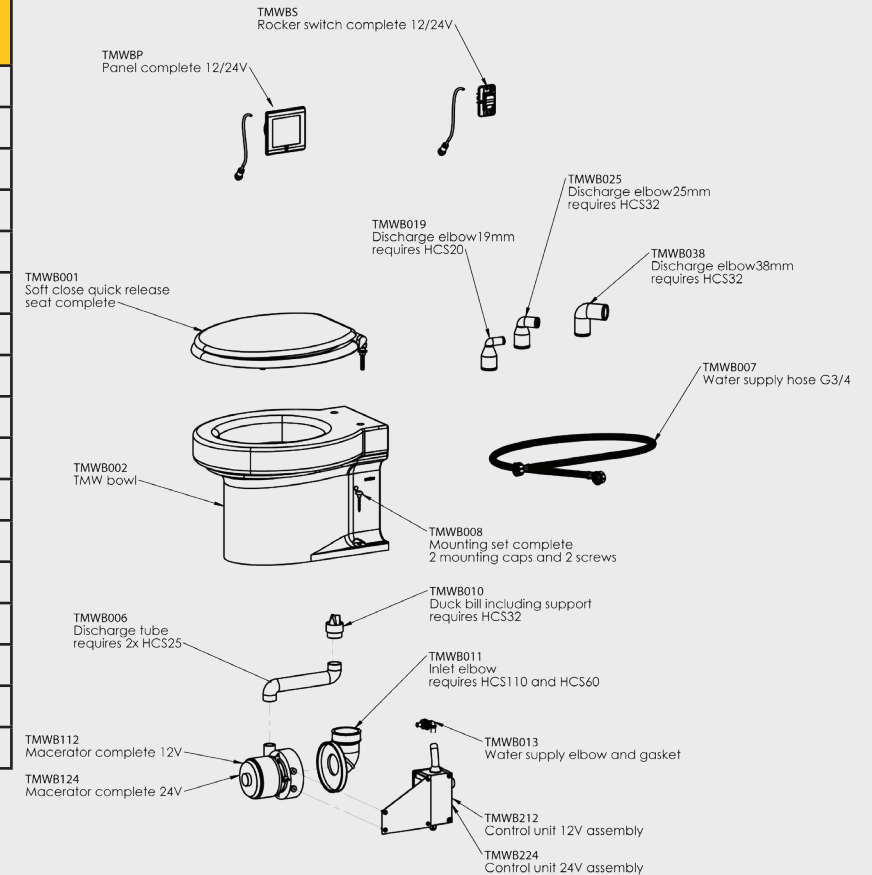



	<i>SMT0</i>	<i>SMT02</i>	<i>SMT025</i>	<i>WCP</i>	<i>WCPS</i>	<i>HATO</i>	<i>HATO2</i>	<i>WCL</i>	<i>WCL2</i>	<i>WCS</i>	<i>WCS2</i>
Non-return valve	SET0167	CLAPDOM	CLAPDOM	CLAPDOM	CLAPDOM	N/A	CLAPDOM	WC008	CLAPDOM	WC008	CLAPDOM
Non-return valve holder	N/A	N/A	N/A	N/A	N/A	N/A	N/A	WC007	N/A	WC007	N/A
Discharge hose with breather	N/A	N/A	N/A	N/A	N/A	N/A	N/A	N/A	SET0162	N/A	SET0161
Elbow piece watersupply	SET0157	SET0157	SET0157	SET0157	SET0157	N/A	N/A	SET0158	SET0158	SET0157	SET0157
Air relief valve/siphon breather	N/A	N/A	N/A	N/A	N/A	WC003	WC003	WC003	SET0162	WC003	SET0161
Push button	WC002	N/A	N/A	N/A	N/A	WC002	N/A	WC002	N/A	WC002	N/A
Pressure switch (pneumatic)	WC009	N/A	N/A	N/A	N/A	WC009	N/A	WC009	N/A	WC009	N/A
Solenoid/Magnetic valve 12 volt	WC005	WC005	WC005	WC005	WC005	WC005	WC005	WC005	WC005	WC005	WC005
Solenoid/magnetic valve 24 volt	WC0054	WC0054	WC0054	WC0054	WC0054	WC0054	WC0054	WC0054	WC0054	WC0054	WC0054
Solenoid/magnetic valve 120 volt	N/A	N/A	N/A	N/A	N/A	N/A	N/A	N/A	N/A	WC11001	N/A
Solenoid/Magnetic valve 230 volt	N/A	N/A	N/A	N/A	N/A	WC22002	N/A	WC22002	N/A	WC22002	N/A
Printed circuit board/ Timer 12 V	SMT0014	SET 0140	SET0140	SET0140	N/A	HATO025	SET0143	WC001	SET0140	WC001	SET0140
Printed circuit board/ Timer 24 V	SMT0014	SET 0140	SET0140	SET0140	N/A	HATO025	SET0143	WC001	SET0140	WC001	SET0140
Printed circuit board/ Timer 120 V	N/A	N/A	N/A	N/A	N/A	SET0169	N/A	SET0168	N/A	SET0168	N/A
Printed circuit board/ Timer 230 V	N/A	N/A	N/A	N/A	N/A	WC22001	N/A	WC22001	N/A	WC22001	N/A
Intermediate cable PCB=>panel	N/A	FLATCABLE	N/A	FLATCABLE	N/A	N/A	FLATCABLE	N/A	FLATCABLE	N/A	FLATCABLE
12 V Macerator, motor and pump	N/A	SET0141	SET0214	SET0216	SET0218	SET0146	SET0146	WC012	SET0138	WC012	SET0138
24 V Macerator, motor and pump	N/A	SET0142	SET0215	SET0217	SET0215	HATO0024	SET0147	WC024	SET0139	WC024	SET0139



	<i>SMT0</i>	<i>SMT02</i>	<i>SMT02S</i>	<i>WCP</i>	<i>WCPS</i>	<i>HATO</i>	<i>HATO2</i>	<i>WCL</i>	<i>WCL2</i>	<i>WCS</i>	<i>WCS2</i>
120V motor (all except bowl/seat/panel)	N/A	N/A	N/A	N/A	N/A	N/A	N/A	WC11002	N/A	WC 11002	N/A
230V motor (all except bowl/seat/panel)	N/A	N/A	N/A	N/A	N/A	N/A	N/A	SET0145	N/A	SET0144	N/A
electronic control panel 12/24 volt	N/A	SET0137	N/A	SET0137	N/A	N/A	SET0137	N/A	SET0137	SET0137	SET0137
Rocker switch 12/24 volt	N/A	N/A	SET0212	N/A	SET0212	N/A	N/A	N/A	N/A	N/A	N/A
Toilet seat set	USEAT	USEAT	USEAT	USEAT	USEAT	HAT0001	HAT0001	WCL001	WCL001	USEAT	USEAT



THRUSTER	MOTOR TYPE	MOTOR	SOLENOID SET	ZINC ANODE	PROPELLER KIT	CARBON BRUSHES	TAIL PIECE	PROPELLER DRIVE PINS	COUPLING SHEAR PIN	COUPLING
BOW23 to 5-95	MBT114M	SET0021	BP94	ZINK02C	BP90S	SET0023	SET0113	BP89	N/A	SET0010
BOW23 to 2-97	MBT114M	SET0021	BP94	ZINK02C	BP90S	BP243	SET0113	BP89	N/A	SET0010
BOW23A	B11.214	SET0021	SET0009	SET0153	BP90S	AL100	SET0113	BP89	N/A	SET0010
BOW25	11216252	SET0007	SET0009	SET0148	SET0086	BP1187	SET0011	BP1168	N/A	SET0010
BOW2512	N/A	SET0007	SET0009	SET0148	SET0086	BP1187	SET0011	BP1168	N/A	SET0010
BOW2512B	N/A	SET0007	SET0009	SET0148	SET0086	BP1187	SET0011	BP1168	N/A	SET0010
BOW2512C/D(I)	N/A	SET0007	SET0009	SET0148	SET0086	BP1187	SET0011	BP1168	N/A	SET0010
BOW35	B11.214	SET0021	SET0009	SET0149	SET0087	AL100	SET0017	BP1129	N/A	SET0022
BOW3512	11.216.260	SET0021	SET0009	SET0149	SET0087	BP1187	SET0017	BP1129	N/A	SET0022
BOW3512B	11.216.260	SET0021	SET0009	SET0149	SET0087	BP1187	SET0017	BP1129	N/A	SET0022
BOW3512C/D (I)	11.216.260	SET0021	SET0009	SET0149	SET0087	BP1187	SET0017	BP1129	N/A	SET0022
BOW4512D (I)	EC 3/1.2/29-02	SET0060	SET0015	SET0149	BP4505	BP60A	BP4520	BP1019	N/A	BP1202
BOW5012 to 6-86	(BP01) R125/3-514/511	BP812*	SET0015	SET0153	SET0089	BP60	BP276	BP381	BP65S	BP134
BOW5012 to 3-93	(BP812) TF12	BP812*	SET0015	SET0153	SET0089	BP60A	BP276	BP381	BP65S	BP134
BOW5012 to 4-95	(BP812) 341-85-022	BP812*	SET0015	SET0153	SET0089	BP20912	BP276	BP381	BP65S	BP134
BOW5012 to 8-00	R125/3-677/634	BP812*	SET0015	SET0153	SET0088	BP261	BP276	BP275S	BP65S	BP134
BOW5024 to 6-86	(BP0124) R125/3-514/512	BP824*	SET0020	SET0153	SET0089	BP60A	BP276	BP381	BP65S	BP134
BOW5024 to 3-93	(BP0124A) TF12	BP824*	SET0020	SET0153	SET0089	BP60A	BP276	BP381	BP65S	BP134
BOW5024 to 4-95	(BP0124A) 341-85-022	BP824*	SET0020	SET0153	SET0089	BP20912	BP276	BP381	BP65S	BP134
BOW5024 to 8-00	R125/3-677/634	BP824*	SET0020	SET0153	SET0088	BP261	BP276	BP275S	BP65S	BP134
BOW5512 to 11-04	R125-633	BP1026*	SET0015	SET0149	SET0087	BP261	SET0078	BP1129	BP1130	BP1023
BOW5512A to 5-06	EC3/1.2/29	SET0060	SET0015	SET0149	SET0087	SET0126	SET0078	BP1129	N/A	BP1202
BOW5512B	EC3/1.2/29	SET0060	SET0015	SET0149	SET0087	SET0126	SET0078	BP1129	N/A	BP1202
BOW5512C/D (I)	EC3/1.2/29-02	SET0060	SET0015	SET0149	SET0087		SET0078	BP1129	N/A	BP1202
BOW5524 to 11-04	R125-633	BP1051*	SET0020	SET0149	SET0087	BP261	SET0078	BP1129	BP1130	BP1023
BOW5524A to 5-06	EC/2.4/33	SET0108	SET0020	SET0149	SET0087	SET0127	SET0078	BP1129	N/A	BP1202
BOW5524B	EC/2.4/33	SET0108	SET0020	SET0149	SET0087	SET0127	SET0078	BP1129	N/A	BP1202

* Electric motor without solenoid



THRUSTER	MOTOR TYPE	MOTOR	SOLENOID SET	ZINC ANODE	PROPELLER KIT	CARBON BRUSHES	TAIL PIECE	PROPELLER DRIVE PINS	COUPLING SHEAR PIN	COUPLING
BOW5524C/D (I)	EC 3/2.4/33-02	SET0108	SET0020	SET0149	SET0087	SET0127	SET0078	BP1129	N/A	BP1202
BOW55HM/B/C/D	N/A	N/A	N/A	SET0149	SET0087	N/A	SET0078	BP1129	N/A	BP1262
BOW6012	R125-633	SET0060	SET0015	SET0150	SET0088	BP261	SET0091	BP275S	N/A	BP1202
BOW6012B	EC3/1.2/29-01	SET0060	SET0015	SET0150	SET0088	SET0126	SET0091	BP275S	N/A	BP1202
BOW6012C/D	EC3/1.2/29	SET0060	SET0015	SET0150	SET0088	SET0126	SET0091	BP275S	N/A	BP1202
BOW6024	R125-634	SET0108	SET0020	SET0150	SET0088	BP261	SET0091	BP275S	N/A	BP1202
BOW6024B	EC/2.4/33	SET0108	SET0020	SET0150	SET0088	SET0127	SET0091	BP275S	N/A	BP1202
BOW6024C/D	EC3/2.4/33	SET0108	SET0020	SET0150	SET0088	SET0127	SET0091	BP275S	N/A	BP1202
BOW7512	TSL125A-681	SET0031	SET0015	SET0150	SET0088	SET0029	SET0035	BP275S	N/A	BP1202
BOW7512B	EC 4.4/1.2/29	SET0031	SET0015	SET0150	SET0088	SET0126	SET0035	BP275S	N/A	BP1202
BOW7512C/D (I)	EC 4.4/1.2/29	SET0031	SET0015	SET0150	SET0088	SET0126	SET0035	BP275S	N/A	BP1202
BOW7524	TSL125A	SET0109	SET0015	SET0150	SET0088	BP1249	SET0035	BP275S	N/A	BP1202
BOW7524B	EC 4.4/2.4/29	SET0109	SET0020	SET0150	SET0088	SET0127	SET0035	BP275S	N/A	BP1202
BOW7524C/D (I)	EC 4.4/2.4/29	SET0109	SET0020	SET0150	SET0088	SET0127	SET0035	BP275S	N/A	BP1202
BOW8012	R160/4.7-9/6	BP26912*	SET0111	SET0150	SET0088	BP238	BP816S	BP275S	BP228S	BP225+226
BOW8024	R160/4.7-9/7	BP26924*	SET0020	SET0150	SET0088	BP238	BP816S	BP275S	BP228S	BP225+226
BOW9512	TSL150-861	SET0041	SET0111	SET0150	SET0088	SET0040	SET0046	BP275S	N/A	BP1202
BOW9512B	EC 5.7/1.2/39-02	SET0041	SET0111	SET0150	SET0088	SET0128	SET0046	BP275S	N/A	BP1202
BOW9512C/D (I)	EC 5.7/1.2/39-02	SET0041	SET0111	SET0150	SET0088	SET0128	SET0046	BP275S	N/A	BP1202
BOW9524	TSL150-861	SET0110	SET0044	SET0150	SET0088	SET0040	SET0046	BP275S	N/A	BP1202
BOW9524B	EC 5.7/2.4/39-02	SET0110	SET0044	SET0150	SET0088	SET0129	SET0046	BP275S	N/A	BP1202
BOW9524C/D (I)	EC 5.7/2.4/39-02	SET0110	SET0044	SET0150	SET0088	SET0129	SET0046	BP275S	N/A	BP1202
BOW95HM/B/C/D		HT5420	N/A	SET0150	SET0088	N/A	SET0046	BP275S	N/A	BP1262
BOW11024	136 602 031(BP115)	SET0079	SET0044	SET0151	SET0090	N/A	SET0080	N/A	N/A	BP117
BOW12512	TSL150-861	SET0159	SET0186	SET0151	SET0090	SET0040	SET0163	N/A	N/A	BP1321
BOW12512B	EC 5.7/1.2/39-02	SET0159	SET0186	SET0151	SET0090	SET0128	SET0163	N/A	N/A	BP1321
BOW12512C/D	EC 5.7/1.2/39-02	SET0159	SET0186	SET0151	SET0090	SET0040	SET0163	N/A	N/A	BP1321
BOW1252DI	EC 5.7/1.2/39-02	SET0159	SET0186	SET0151	SET0090	SET0040	SET0163	N/A	N/A	BP1321
BOW12524	EC 5.7/2.4/39-02	SET0110	SET0044	SET0151	SET0090	SET0040	SET0163	N/A	N/A	BP1321

* Electric motor without solenoid



THRUSTER	MOTOR TYPE	MOTOR	SOLENOID SET	ZINC ANODE	PROPELLER KIT	CARBON BRUSHES	TAIL PIECE	PROPELLER DRIVE PINS	COUPLING SHEAR PIN	COUPLING
BOW12524B	EC 5.7/2.4/39-02	SET0160	SET0044	SET0151	SET0090	SET0129	SET0163	N/A	N/A	BP1321
BOW12524C/D	EC 5.7/2.4/39-02	SET0160	SET0044	SET0151	SET0090	SET0129	SET0163	N/A	N/A	BP1321
BOW1254DI	EC 5.7/2.4/39-02	SET0160	SET0044	SET0151	SET0090	SET0129	SET0163	N/A	N/A	BP1321
BOW13024	R178 (BP239)	SET0079	SET0044	SET0151	SET0090	SET0040	SET0080	N/A	N/A	BP117
BOW16024	84633	BP239A	BP1039	SET0151	BP125	BP233	SET0080	N/A	N/A	BP117
BOW16024A	TSL178A-676 (BP305)	SET0079	SET0044	SET0151	SET0090	SET0040	SET0080	N/A	N/A	BP117
BOW160B	EC7/2.4/26-04	SET0079	SET0044	SET0151	SET0090	SET0130	SET0080	N/A	N/A	BP117
BOW16024B	EC7/2.4/26-04	SET0079	SET0044	SET0151	SET0090	SET0130	SET0080	N/A	N/A	BP117
BOW16024C/D	EC7/2.4/26-04	SET0079	SET0044	SET0151	SET0090	SET0130	SET0080	N/A	N/A	BP117
BOW160HM	8.5 cc max 215 bar	HT5054	N/A	SET0151	SET0090	N/A	SET0080	N/A	N/A	BP117
BOW160HMB/C	8.5 cc max 280 bar	HT5421	N/A	SET0151	SET0090	N/A	SET0080	N/A	N/A	BP902
BOW22024	EC11/2.4/20	BP1010*	SET0176	SET0152	BP3074	SET0057	SET0164	N/A	N/A	BP1074
BOW22024C/D	EC11/2.4/20	BP1010*	SET0176	SET0152	BP3074	SET0131	SET0164	N/A	N/A	BP1074
BOW230HMC	SNM2/17 CI06 LFU1C	HT5504	N/A	SET0152	BP3074	N/A	SET0164	N/A	N/A	BP1358
BOW28548	EC17.5/4.8/24	BP3006*	SET0176	SET0152	BP3074	SET0132	SET0165	N/A	N/A	BP1074
BOW28548C/D	EC17.5/4.8/24	BP3006*	SET0176	SET0152	BP3074	SET0132	SET0165	N/A	N/A	BP1074
BOW300HM	26 cc max 230 bar	HT5422	N/A	SET0152	BP3074	N/A	SET0165	N/A	N/A	BP1115
BOW310HMC	26 cc max 270 bar	HT5422	N/A	SET0152	BP3074	N/A	SET0165	N/A	N/A	BP1115

* Electric motor without solenoid



HOSE	SUPPORT RING	FITTING	SLEEVES
HS04N /HS100N 6x8 mm	HS1011S	Fitting HS1010MS for HTP pump	HS10131 (10 sleeves and support rings)
		fittings of BYPASS8 use	HS10131 (10 sleeves and support rings)
		fittings of HS211 use	HS10131 (10 sleeves and support rings)
HHOSE60-- /HHOSE6100 6x10mm	HS145S	HS1039MS/1037MS for HTP pump	SET0173
		HS868/HS213 use	SET0174
		fittings in KITK52175 for K30/140	SET0173
		fittings for BYPASS10 use	SET0174
		Fittings for HTP pumps 10 mm use	SET0173
		T-couplings HS868 for MTC 52 to 175 use	SET0174
		not needed	not needed
HHOSE80--/HHOSE8100 8x12 mm	not needed	HS1031MS/HS1037MS	not needed
		fittings in KITK30 for K30/140 use	SET0173
		fittings for BYPASS10 use	SET0174
		Fittings for HTP pumps 10 mm use	SET0173
		T-couplings HS868 for MTC 52 to 175 use	SET0174



VETUS offers two different types of steering pumps; steering pumps without non-return valve (type HTP) and steering pumps with integral non-return valve and pressure relief valve (type HTPR).

Type 20

Specifications:

- Capacity: 19,7 cm³/rev.
- Number of pistons: 5
- Weight without valve: 3.3 kg
- Weight with valve: 4,1 kg



HTP20



HTP20R

Type 30

Specifications:

- Capacity: 30,0 cm³/rev.
- Number of pistons: 5
- Weight without valve: 3.3 kg
- Weight with valve: 4,1 kg



HTP30



HTP30R

Type 42

Specifications:

- Capacity: 42,0 cm³/rev.
- Number of pistons: 7
- Weight without valve: 3.3 kg
- Weight with valve: 4,1 kg



HTP42



HTP42R

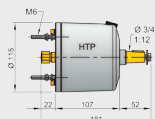

HTP

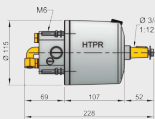

HTPR

This table shows which pump matches with which type of cylinder.

	Pump type 20	Pump type 30	Pump type 42
<p>Stroke: 150 mm Volume: 67 cm³ Length of tiller arm: 129 mm Weight: 1.8 kg</p>	<p>Wheel turns: 3.4</p> <p>Max. Torque: 294 Nm (30 kgm) (216 ft.lbs) Tubing: nylon hose Ø 6 x Ø 8 mm</p>	N/A	N/A
<p>Stroke: 160 mm Volume: 104 cm³ Length of tiller arm: 140 mm Weight: 3.4 kg</p>	<p>Wheel turns: 5.3</p> <p>Max. Torque: 510 Nm (52 kgm) (376 ft.lbs). Torque at 35° and 56 kg/cm²: 412 Nm (42 kgm) (304 ft.lbs) Tubing: nylon hose Ø 6 x Ø 10 mm copper Ø 8 x Ø 10 mm</p>	<p>Wheel turns: 3.5</p> <p>Max. Torque: 510 Nm (52 kgm) (376 ft.lbs). Torque at 35° and 56 kg/cm²: 412 Nm (42 kgm) (304 ft.lbs) Tubing: nylon hose Ø 6 x Ø 10 mm or Ø 8 x Ø 12 mm copper Ø 8 x Ø 10 mm</p>	N/A
<p>Stroke: 225 mm Volume: 146 cm³ Length of tiller arm: 196 mm Weight: 3.8 kg</p>	<p>Wheel turns: 7.5</p> <p>Max. Torque: 706 Nm (72 kgm) (521 ft.lbs). Torque at 35° and 56 kg/cm²: 589 Nm (60 kgm) (434 ft.lbs) Tubing: nylon hose Ø 6 x Ø 10 mm or copper Ø 8 x Ø 10 mm</p>	<p>Wheel turns: 4.9</p> <p>Max. Torque: 706 Nm (72 kgm) (376 ft.lbs). Torque at 35° and 56 kg/cm²: 589 Nm (60 kgm) (434 ft.lbs) Tubing: nylon hose Ø 6 x Ø 10 mm or Ø 8 x Ø 12 mm or copper Ø 8 x Ø 10 mm</p>	<p>Wheel turns: 3.5</p> <p>Max. Torque: 706 Nm (72 kgm) (376 ft.lbs). Torque at 35° and 56 kg/cm²: 589 Nm (60 kgm) (434 ft.lbs) Tubing: nylon hose Ø 6 x Ø 10 mm or Ø 8 x Ø 12 mm or copper Ø 8 x Ø 10 mm</p>
<p>Stroke: 160 mm Volume: 253 cm³ Length of tiller arm: 140 mm Weight: 7.1 kg</p>	N/A	<p>Wheel turns: 8.5</p> <p>Max. Torque: 1226 Nm (125 kgm) (904 ft.lbs). Torque at 35° and 56 kg/cm²: 981 Nm (100 kgm) (723 ft.lbs) Tubing: nylon hose Ø 6 x Ø 10 mm or Ø 8 x Ø 12 mm or copper Ø 8 x Ø 10 mm</p>	<p>Wheel turns: 6.1</p> <p>Max. Torque: 1226 Nm (125 kgm) (904 ft.lbs). Torque at 35° and 56 kg/cm²: 981 Nm (100 kgm) (723 ft.lbs) Tubing: nylon hose Ø 6 x Ø 10 mm or Ø 8 x Ø 12 mm or copper Ø 8 x Ø 10 mm</p>
<p>Stroke: 225 mm Volume: 356 cm³ Length of tiller arm: 196 mm Weight: 8 kg</p>	N/A	N/A	<p>Wheel turns: 8.5</p> <p>Max. Torque: 1717 Nm (175 kgm) (1266 ft.lbs). Torque at 35° and 56 kg/cm²: 1373 Nm (140 kgm) (1013 ft.lbs) Tubing: nylon hose Ø 6 x Ø 10 mm or Ø 8 x Ø 12 mm or copper Ø 8 x Ø 10 mm</p>



A large area of the page is filled with horizontal dotted lines, providing a space for handwritten notes.



A large area of the page is filled with horizontal dotted lines, providing a space for handwritten notes.

2014-2015



Vetus

SPARE PARTS

About VETUS

Developing innovative systems for your boat is truly what VETUS is about. VETUS invents and develops systems consisting of a wide range of products to keep your boat in an excellent technical condition.

For almost 50 years VETUS has been one of the world's leading companies when it comes to innovative products for pleasure craft and small commercial vessels. Not for nothing is the VETUS catalogue regularly consulted by the engineers and designers from leading yacht builders and used as educational material in marine training establishments.

VETUS B.V.

Fokkerstraat 571 • 3125 BD Schiedam • Nederland
tel. +31 (0)88 - 48 84 700 • fax +31 (0)88 - 48 84 685
sales@vetus.com • www.vetus.com

All VETUS products and the VETUS brand logos are the exclusive property of VETUS B.V., the Netherlands. They are protected world-wide by international law. We reserve the right to alter product specifications and design without prior notice. Printed in the Netherlands.

CREATORS OF

BOAT SYSTEMS